

SOUTH POOL

NOTICE: Bids will now be accepted via email only to jordanh@superiorcolorado.gov

Bids will not be opened before the deadline. Please submit one PDF of complete bid package and one Bid Schedule in excel format.

RFI #	Sheet	Question / Clarification	Architect / Engineer response
27		The pool geotechnical notes PL200 and geotechnical report note an underdrain/sump for the new pool. The drain is not noted on the civil plans so extent of piping or requirements for sump are unknown.	Please see attached for revised sheets C-4 and C-8 for perimeter drain and detail. The Geotech report showed a drainage liner and drainage layer below the pool. The liner and gravel layer should be installed and made to flow to the perimeter system to be collected.

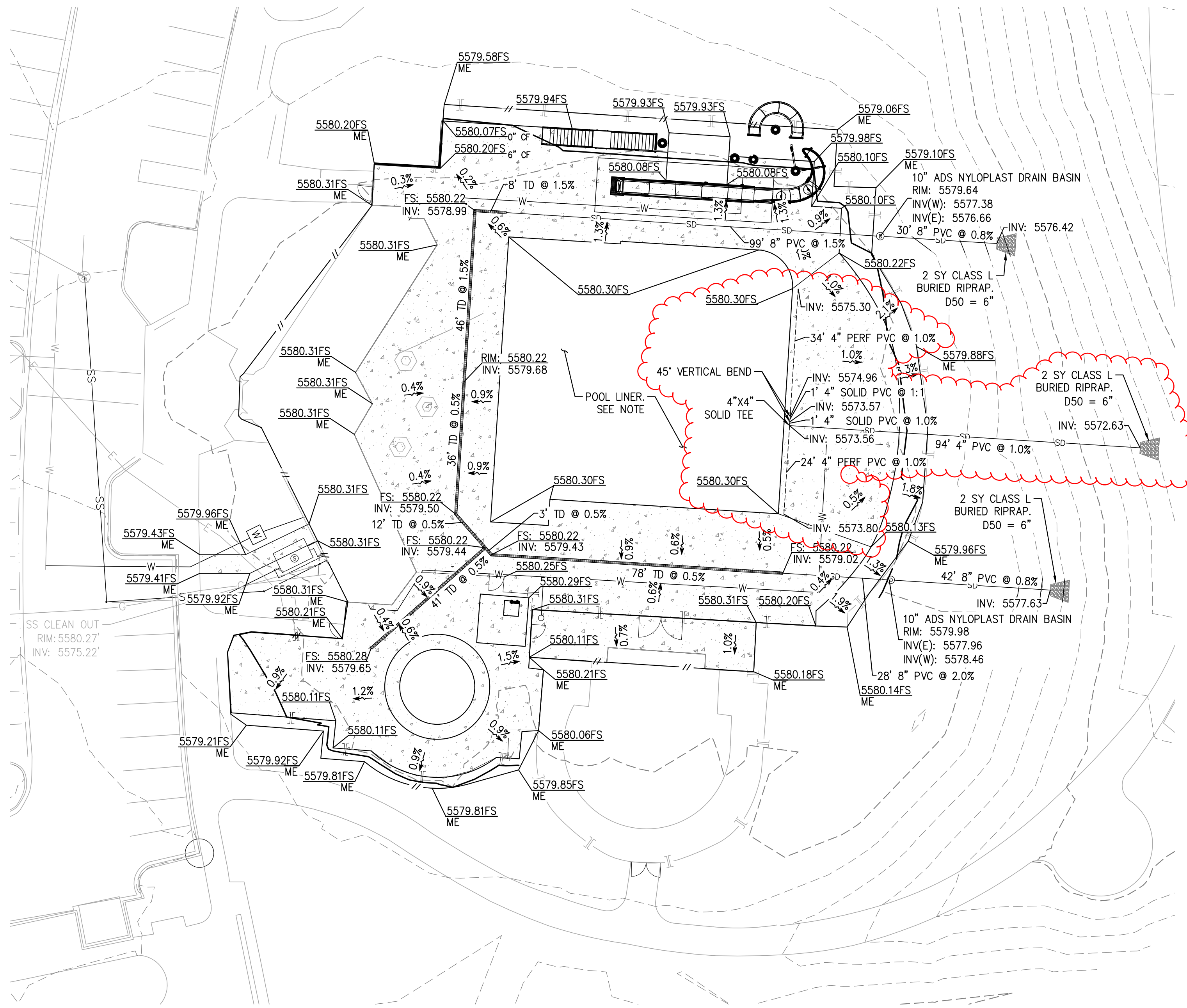

OVERALL GRADING PLAN

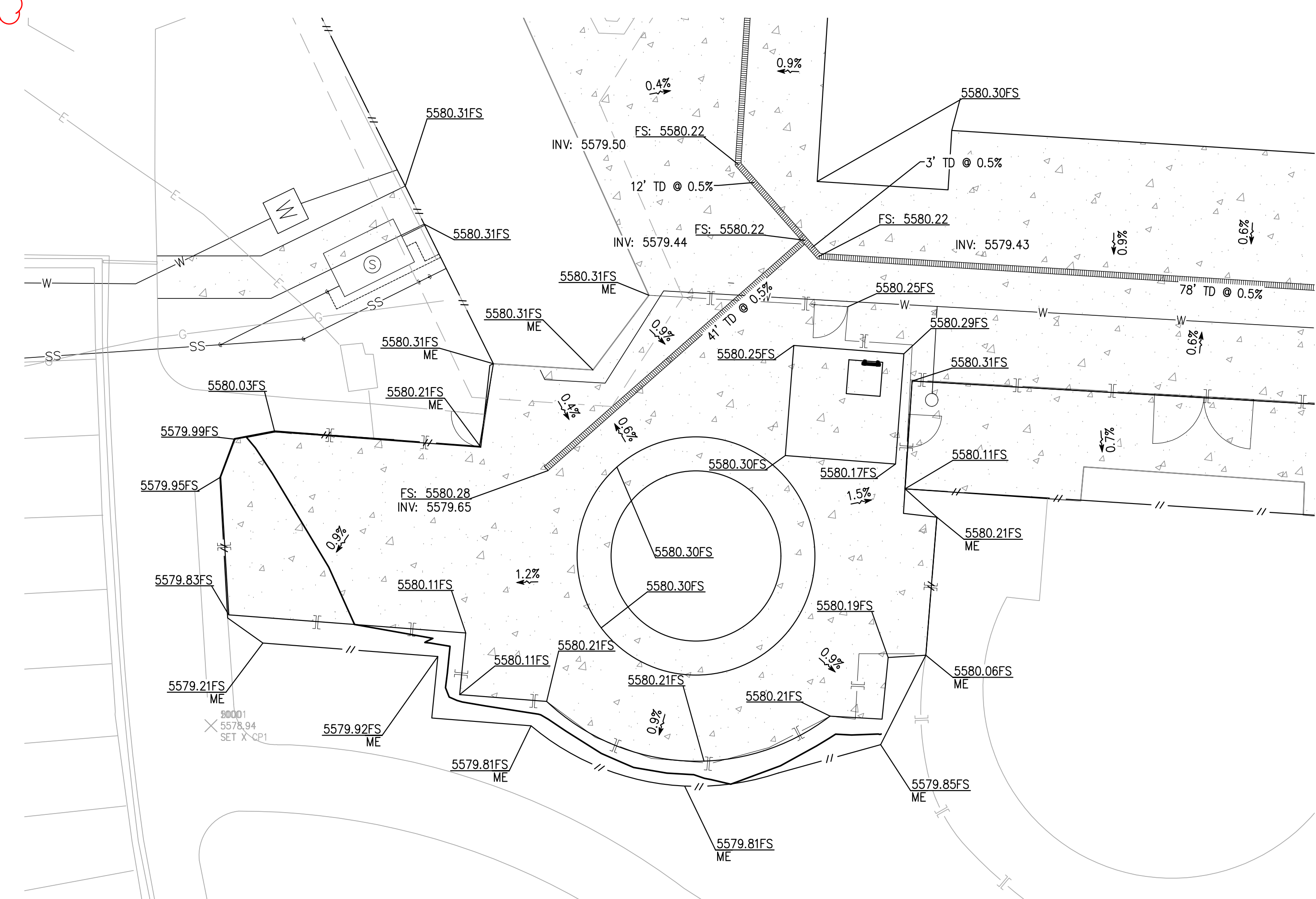

SPLASH PAD DETAILED GRADING PLAN

SITE LEGEND:

SS	EXISTING SANITARY SEWER
W	EXISTING WATER
E	EXISTING ELECTRIC
G	EXISTING GAS
F	EXISTING FENCE
R	PROPOSED RIDGE
SD	PROPOSED STORM PIPE
---	LIMIT OF DISTURBANCE
---	PROPOSED CONCRETE
---	PROPOSED RIPRAP
(D)	PROPOSED STORM MANHOLE

ADA NOTE:

ALL ACCESSIBLE PATHS OF TRAVEL ARE TO ABIDE BY THE FOLLOWING PARAMETERS:

- CROSS-SLOPE NOT TO EXCEED 2%
- LONGITUDINAL SLOPE NOT TO EXCEED 5%
- LONGITUDINAL RAMP SLOPE NOT TO EXCEED 8.33% (LANDING PLACEMENT PER RAMP DETAILS).
- PATHWAYS EXCEEDING THESE STANDARDS WILL BE REPLACED AT THE CONTRACTORS EXPENSE

LINER NOTE:

POOL LINER TO FLOW EAST AT A MINIMUM OF 1% TO FOUNDATION DRAIN. REFER TO DETAIL 3 ON SHEET C-8.

ABBREVIATIONS

BOS	BOTTOM OF STAIRS
BOSS	BOTTOM OF SANITARY SEWER
BW	BOTTOM OF WALL
CF	CURB FACE
EF	EXPOSED FOUNDATION
EG	EXISTING GROUND
ES	EXISTING SURFACE
FF/FFE	FINISHED FLOOR ELEVATION
FL	FLOW LINE
FG	FINISHED GROUND
FS	FINISHED SURFACE
GB	GRADE BREAK
ME	MATCH EXISTING
PERF	PERFORATED PIPE
PL	PROPERTY LINE
RET	RETAINED HEIGHT
R	RIDGE
SW	SIDEWALK
TC	TOP OF CURB
TD	TRENCH DRAIN
TOS	TOP OF STAIRS
TOSD	TOP OF STORM DRAIN
TW	TOP OF WALL

BENCHMARK: NGS BENCHMARK DESIGNATION P 453, EL=5508.96' (NAVD88),
STAINLESS STEEL ROD SET IN A 5-INCH (13 CM) PVC WITH LOGO LID, INSCRIBED--P453 2003--AND SURROUNDED BY A CONCRETE COLLAR, 112 FT (34.1 M) EAST FROM THE SOUTH CORNER OF THE SIGN FOR CENTURA HEALTH, AVISTA ADVENTIST HOSPITAL, 65 FT (19.8 M) NORTH FROM THE NORTHWEST END OF THE GUARDRAIL OVER A CONCRETE BOX CULVERT FOR A FARM ACCESS ROAD, 51 FT (15.5 M) NORTHEAST FROM THE NORTHEAST EDGE OF OIL OF NORTHWEST-BOUND US 36, 33 FT (21.0 M) NORTHWEST FROM THE WOOD CORNER POST OF A WOVEN-WIRE FENCE, 3.8 FT (1.2 M) SOUTHWEST FROM THE FENCE, 2.6 FT (0.8 M) SOUTHWEST FROM A GREEN CARSONITE WITNESS POST.

BASIS OF BEARINGS: N/A



UNAUTHORIZED CHANGES & USES

THE ENGINEER PREPARING THESE PLANS WILL NOT BE RESPONSIBLE FOR, OR LIABLE FOR, UNAUTHORIZED CHANGES TO OR USES OF THESE PLANS. ALL CHANGES OF THESE PLANS MUST BE IN WRITING AND MUST BE APPROVED BY THE PREPARER OF THESE PLANS PRIOR TO CONSTRUCTION. CONSTRUCTION CONTRACTOR AGREES THAT IN ACCORDANCE WITH GENERALLY ACCEPTED CONSTRUCTION PRACTICES, CONSTRUCTION CONTRACTOR WILL BE REQUIRED TO ASSUME SOLE AND COMPLETE RESPONSIBILITY FOR JOB SITE CONDITIONS DURING THE COURSE OF CONSTRUCTION OF THE PROJECT, INCLUDING SAFETY OF ALL PERSONS AND PROPERTY, THAT THIS REQUIREMENT SHALL BE MADE TO APPLY CONTINUOUSLY AND NOT BE LIMITED TO NORMAL WORKING HOURS, AND CONSTRUCTION CONTRACTOR FURTHER AGREES TO DEFEND, INDEMNIFY AND HOLD DESIGN PROFESSIONAL HARMLESS FROM ANY AND ALL LIABILITY, REAL OR ALLEGED, IN CONNECTION WITH THE PERFORMANCE OF WORK ON THIS PROJECT, EXCEPTING LIABILITY ARISING FROM THE SOLE NEGLIGENCE OF DESIGN PROFESSIONAL.

NOTE TO CONTRACTOR

THE EXISTENCE AND LOCATION OF ANY UNDERGROUND UTILITIES, PIPES, AND/OR STRUCTURES SHOWN ON THESE PLANS WERE OBTAINED BY A SEARCH OF AVAILABLE RECORDS. THERE MAYBE EXISTING UTILITIES NOT SHOWN ON THESE PLANS. THE CONTRACTOR SHALL ASCERTAIN THE TRUE VERTICAL AND HORIZONTAL LOCATION OF THOSE UNDERGROUND UTILITIES TO BE USED PRIOR TO CONSTRUCTION AND SHALL BE RESPONSIBLE FOR ANY DAMAGE TO ANY PUBLIC OR PRIVATE UTILITIES, SHOWN OR NOT SHOWN HEREON.

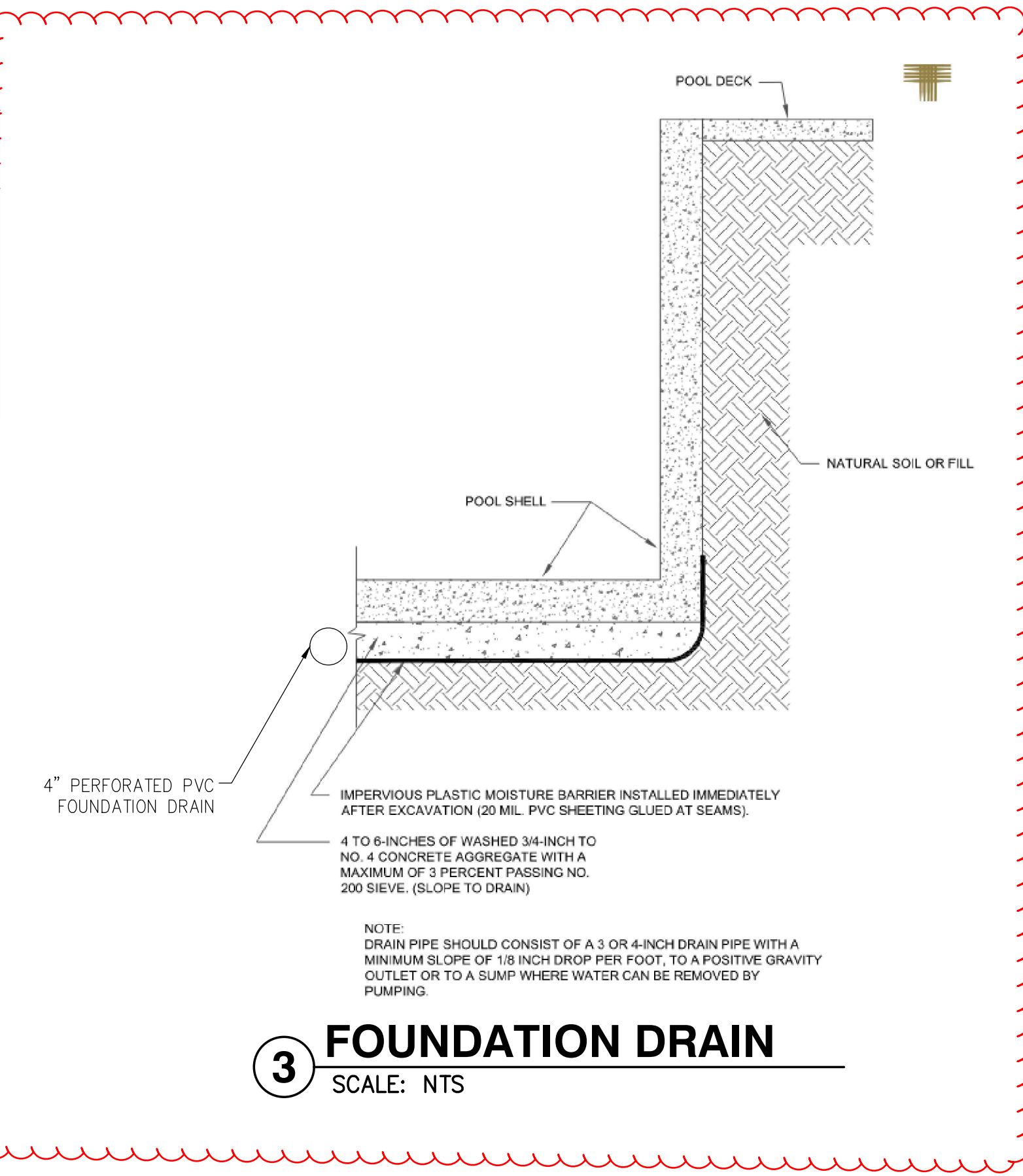
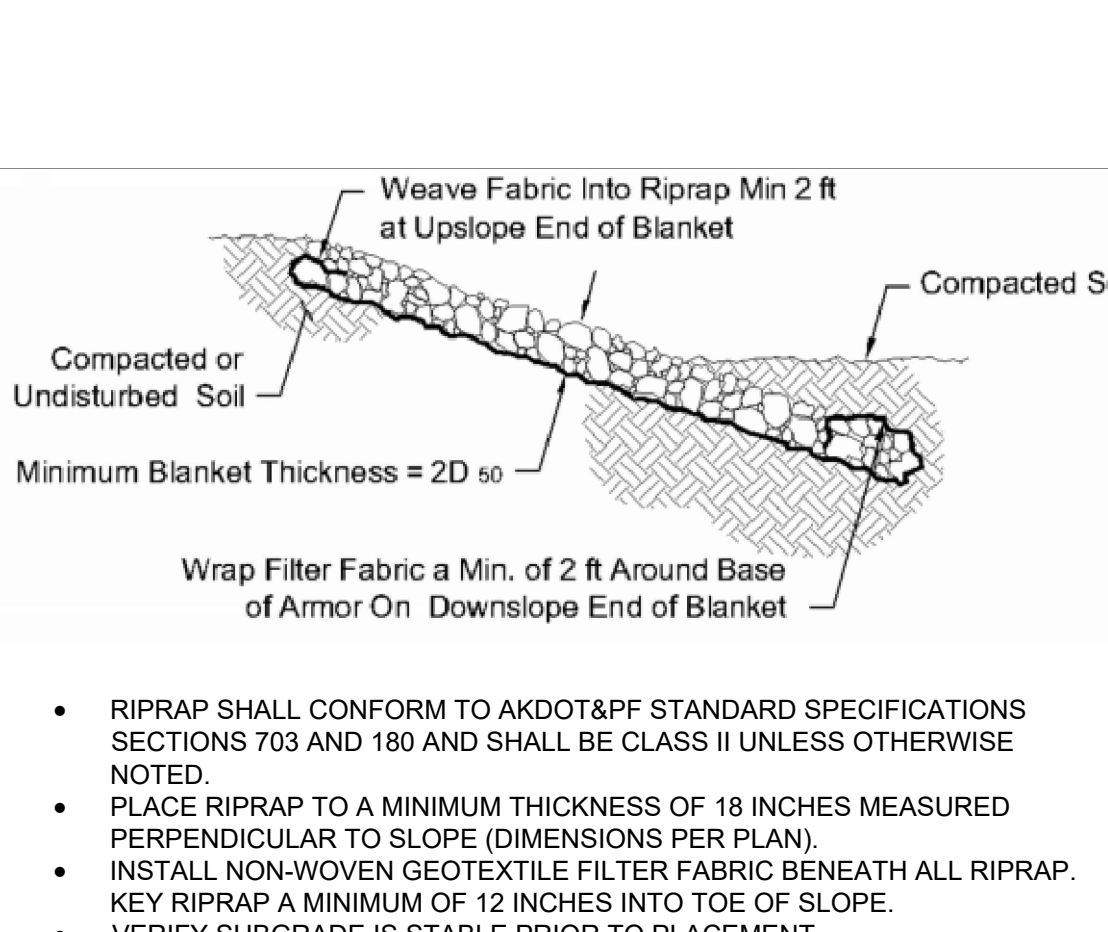
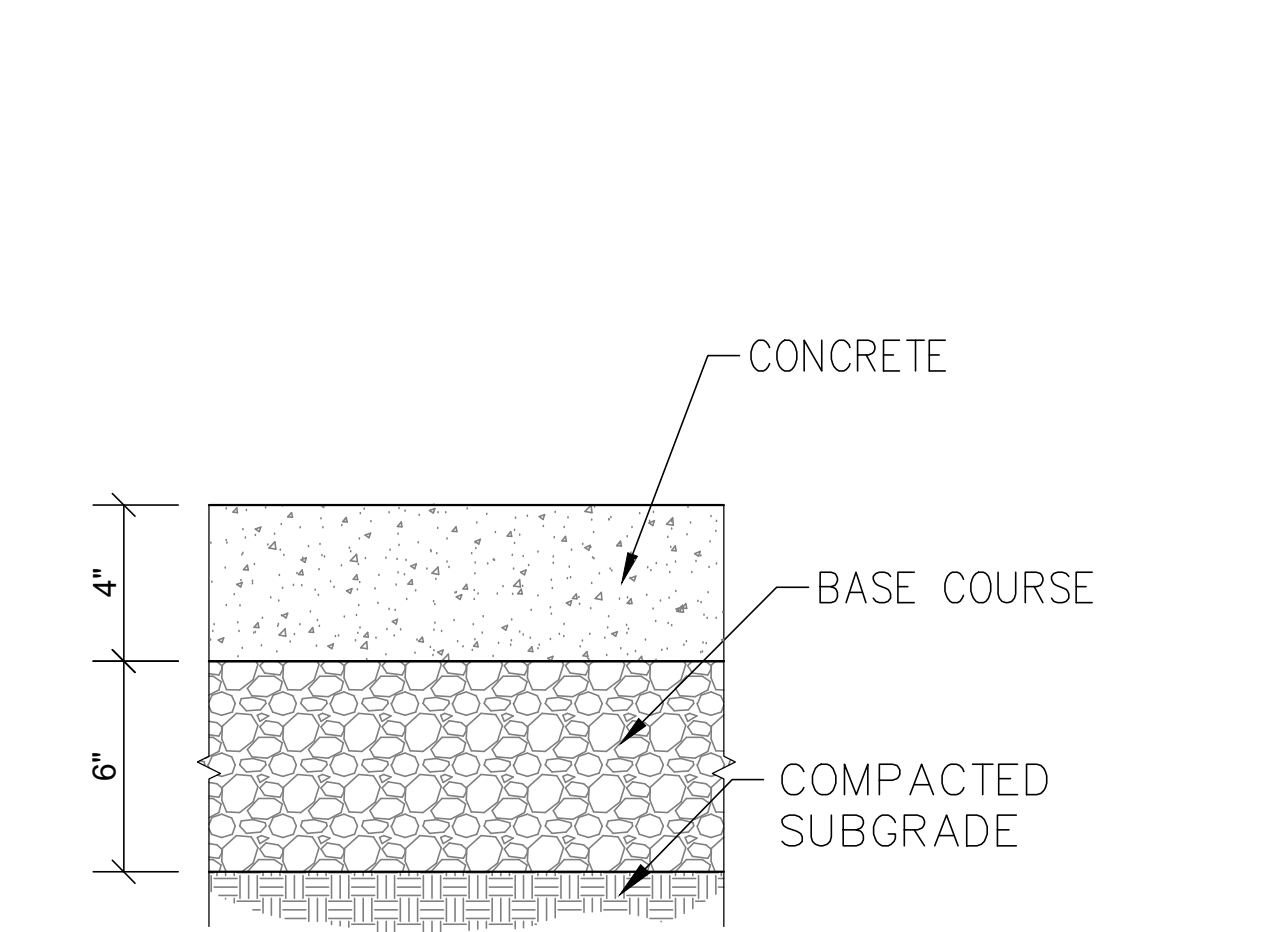
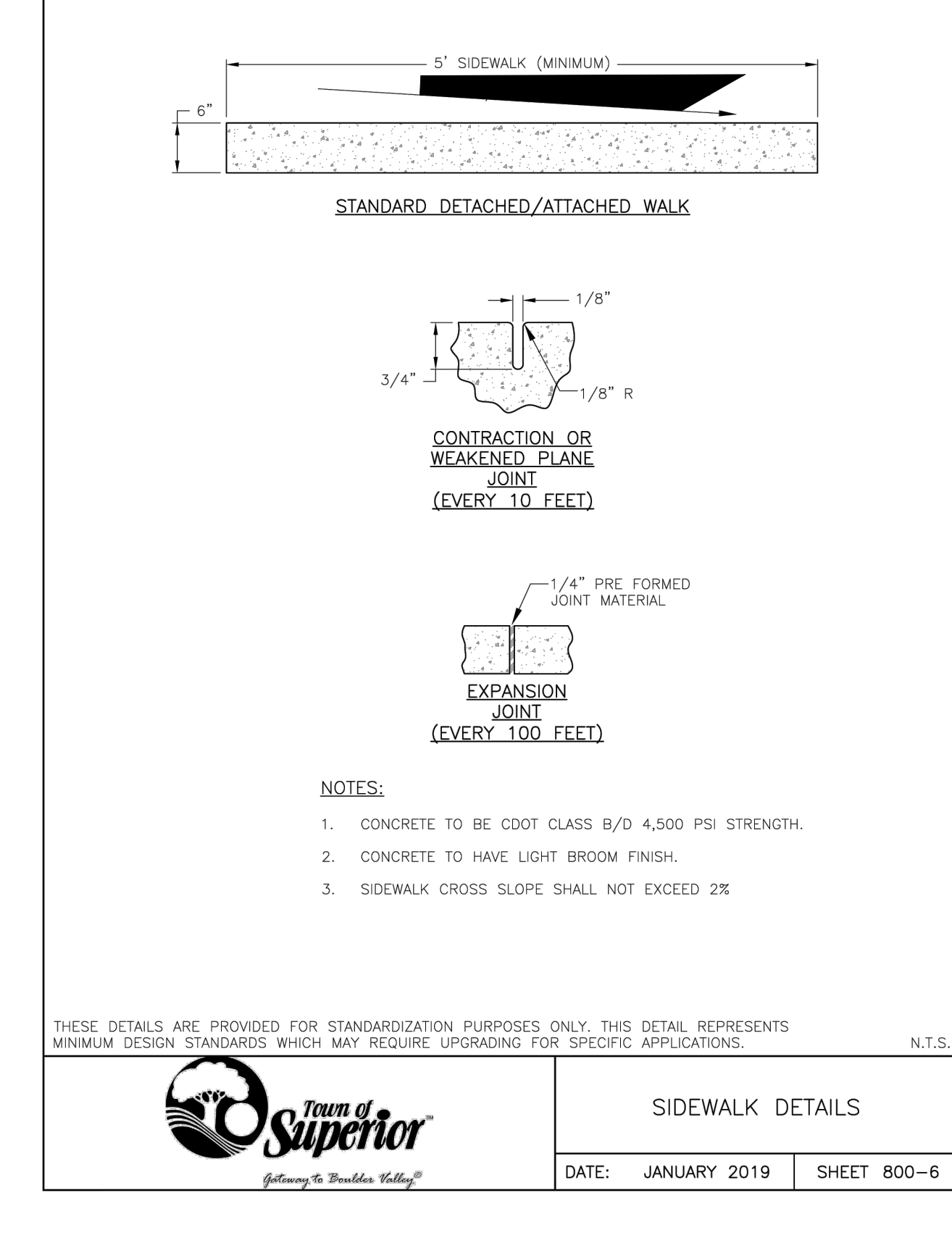
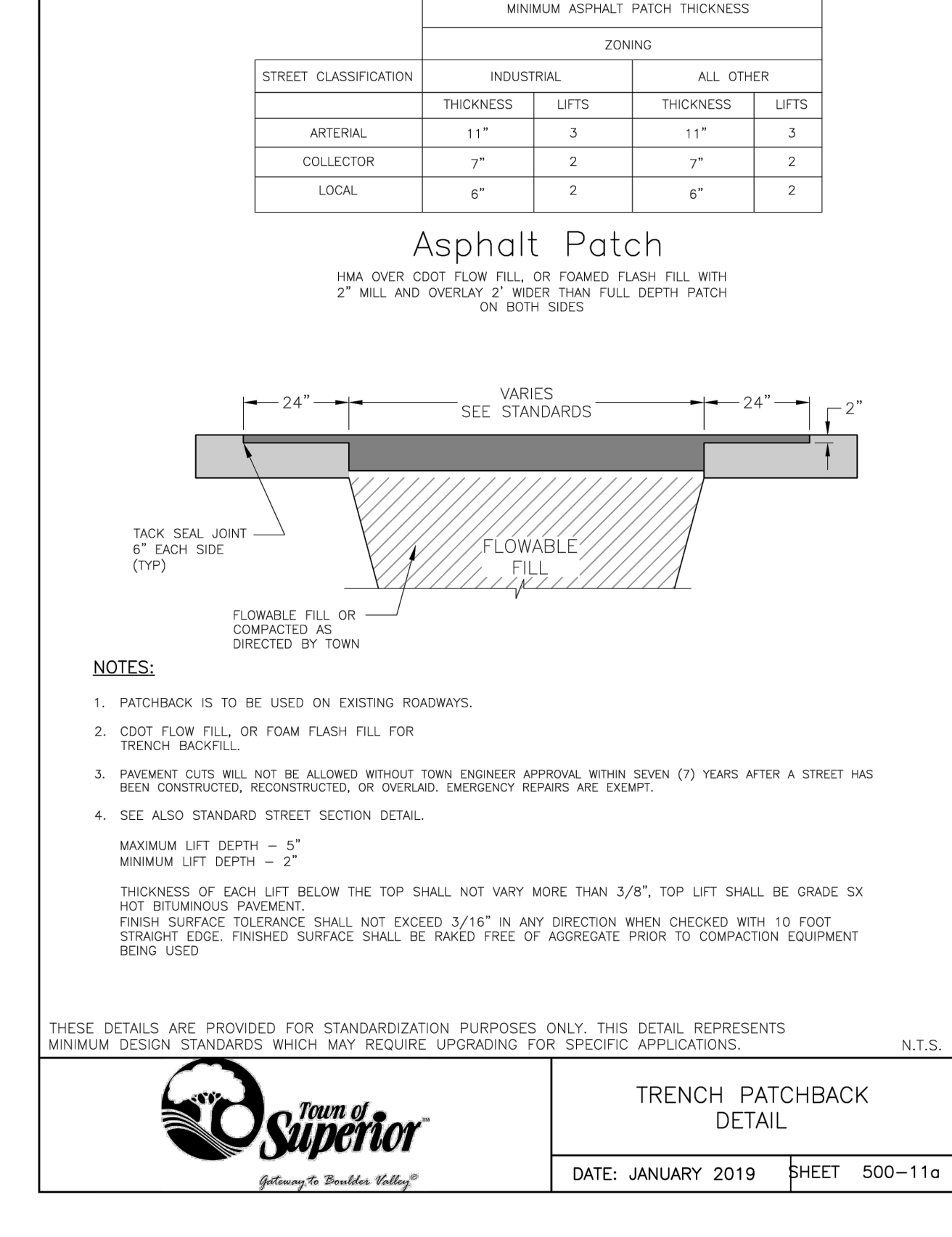
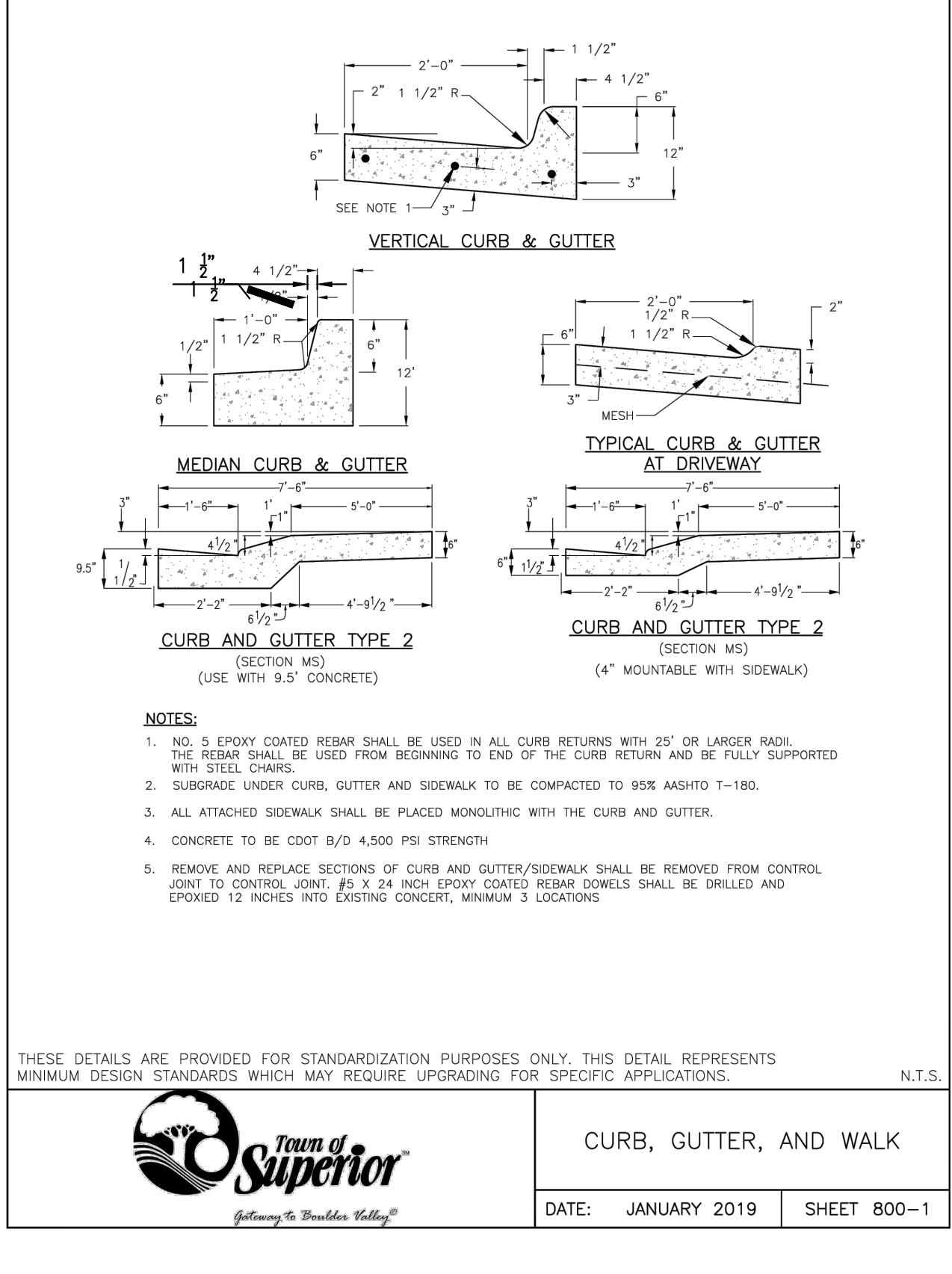
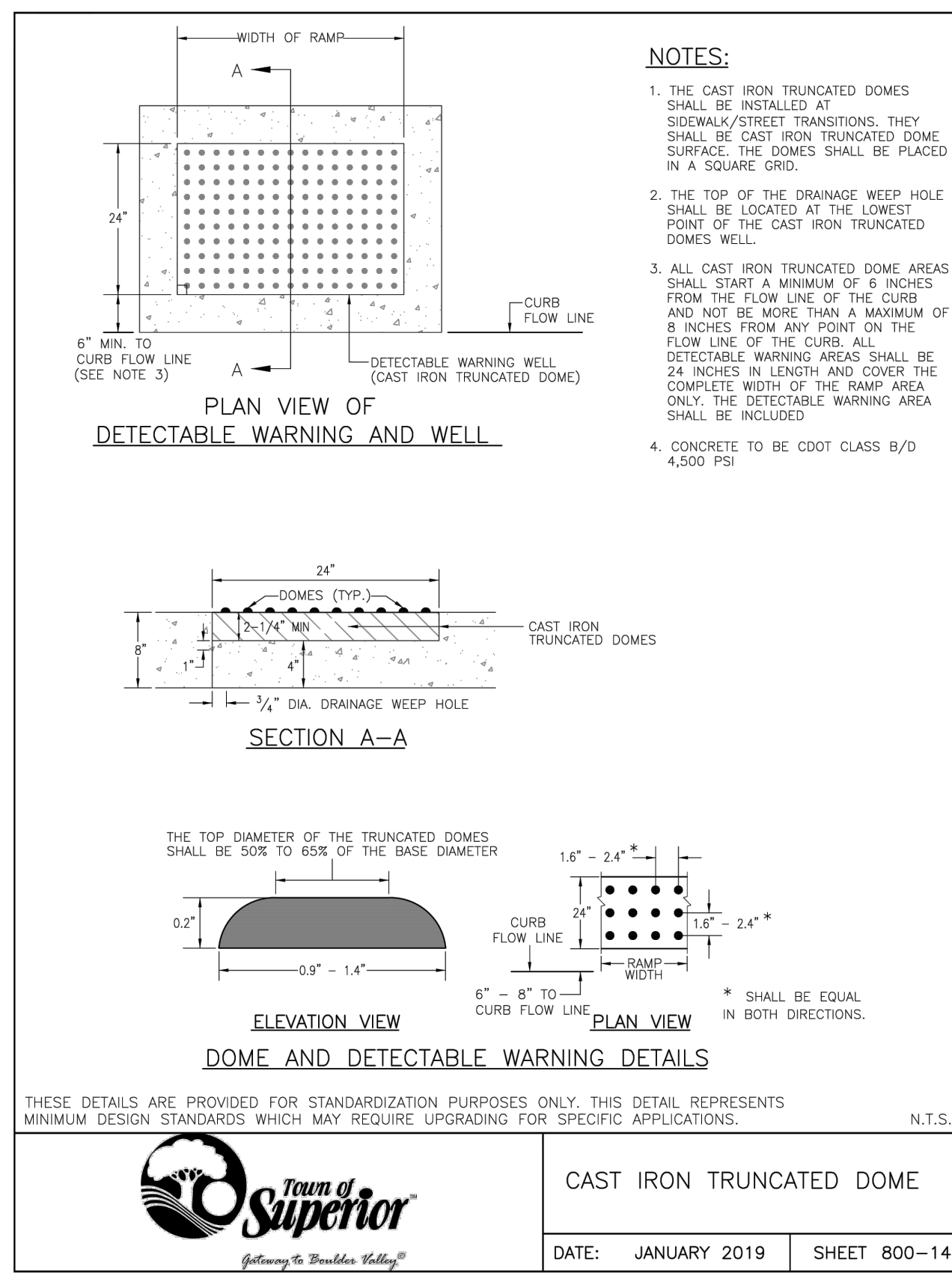

UNAUTHORIZED CHANGES & USES

THE ENGINEER PREPARING THESE PLANS WILL NOT BE RESPONSIBLE FOR, OR LIABLE FOR, UNAUTHORIZED CHANGES TO OR USES OF THESE PLANS. ALL CHANGES OF THESE PLANS MUST BE IN WRITING AND MUST BE APPROVED BY THE PREPARER OF THESE PLANS PRIOR TO CONSTRUCTION. CONSTRUCTION CONTRACTOR AGREES THAT IN ACCORDANCE WITH GENERALLY ACCEPTED CONSTRUCTION PRACTICES, CONSTRUCTION CONTRACTOR WILL BE REQUIRED TO ASSUME SOLE AND COMPLETE RESPONSIBILITY FOR JOB SITE CONDITIONS DURING THE COURSE OF CONSTRUCTION OF THE PROJECT, INCLUDING SAFETY OF ALL PERSONS AND PROPERTY, THAT THIS REQUIREMENT SHALL BE MADE TO APPLY CONTINUOUSLY AND NOT BE LIMITED TO NORMAL WORKING HOURS, AND CONSTRUCTION CONTRACTOR FURTHER AGREES TO DEFEND, INDEMNIFY AND HOLD DESIGN PROFESSIONAL HARMLESS FROM ANY AND ALL LIABILITY, REAL OR ALLEGED, IN CONNECTION WITH THE PERFORMANCE OF WORK ON THIS PROJECT, EXCEPTING LIABILITY ARISING FROM THE SOLE NEGLIGENCE OF DESIGN PROFESSIONAL.

NOTE TO CONTRACTOR

THE EXISTENCE AND LOCATION OF ANY UNDERGROUND UTILITIES, PIPES, AND/OR STRUCTURES SHOWN ON THESE PLANS WERE OBTAINED BY A SEARCH OF AVAILABLE RECORDS. THERE MAY BE EXISTING UTILITIES NOT SHOWN ON THESE PLANS. THE CONTRACTOR SHALL ASCERTAIN THE TRUE VERTICAL AND HORIZONTAL LOCATION OF THOSE UNDERGROUND UTILITIES TO BE USED PRIOR TO CONSTRUCTION AND SHALL BE RESPONSIBLE FOR ANY DAMAGE TO ANY PUBLIC OR PRIVATE UTILITIES, SHOWN OR NOT SHOWN HEREON.



brsarch.com



Superior South Pool

3300 Huron Peak Avenue
Superior, CO 80027

Project Number:	2025.082
Issue:	100% CD
Date:	MARCH 27, 2026
Drawn By:	CV
Checked By:	MEO
Revisions:	
Description	Date:
Foundation Drain Addition	April 21, 2026

Sheet title: **SITE DETAILS**

C-8

© 2025 Barker Rinker Seacat Architecture